

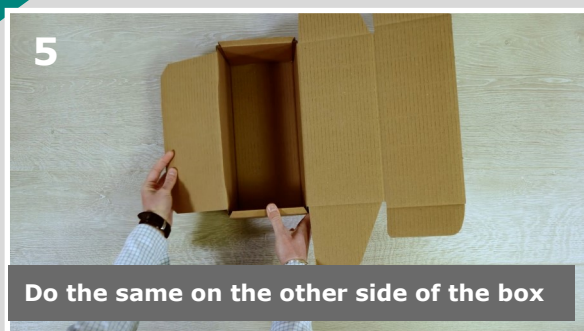

# How to Fold

## UPS Approved Spirits Packaging

Detailed instructions for folding the outer box and insert  
example of box Type A

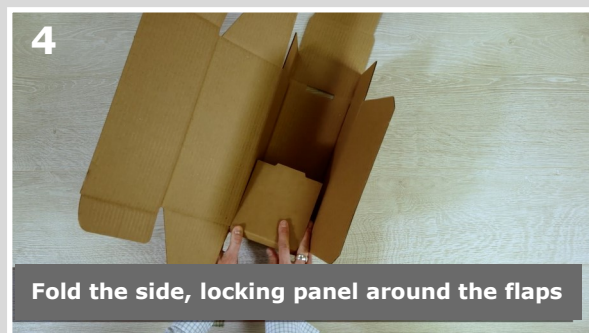

11

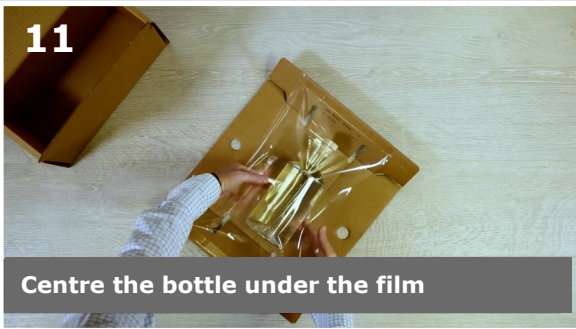

Centre the bottle under the film

12



Fold the top and the bottom flaps back

13

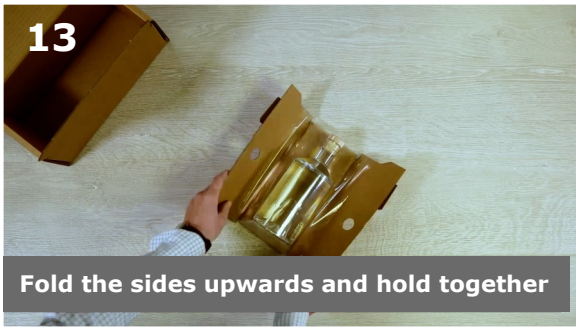

Fold the sides upwards and hold together

14



Place the insert into the box

15



Make sure the bottle is tightly wrapped

16

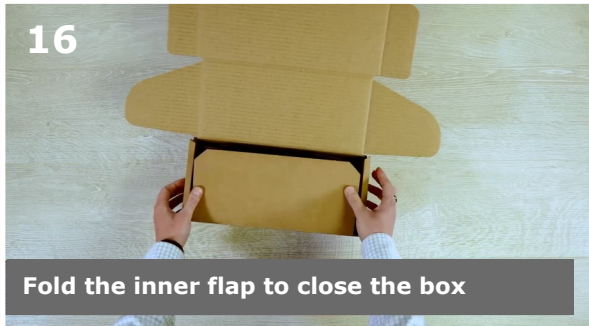

Fold the inner flap to close the box

17



Make sure the bottle is tightly wrapped

18



Tuck in two remaining flaps

19



Seal the box and apply a shipping label

**IMPORTANT TIP:**

Make sure you have selected the right type of box for your bottle. Please refer to the maximum bottle dimensions on the outer box or cited below:

Type A: 245 x 119 x 112 mm

Type B: 270 x 175 x 90 mm

Type C: 355 x 108 x 96 mm

Type D: 318 x 98 x 90 mm

Bottle must be tightly suspended in the film. If the film is loose around the bottle or the bottle moves, it means that the bottle is too small for the selected type.

To view full instructional video, get more information  
and order UPS Approved Spirits Packaging,  
visit [www.ups.com/spiritpack](http://www.ups.com/spiritpack)